

SOLID BEAM STRAPS

SAFETY INSTRUCTIONS

Make sure to use the recommended tools.
Wear proper protective gear.
Follow power tools instructions and users manuals.

SPECIAL INSTRUCTIONS & NOTES

Thoroughly read through the installation instructions to familiarize yourself with the process before beginning installation.

TOOL & MATERIAL LIST

- Construction Adhesive
- Power Drill
- Screws

STEP BY STEP INSTRUCTIONS

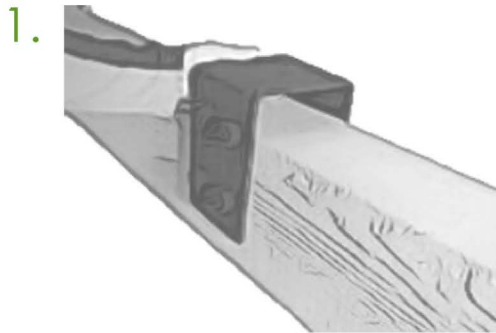

Make sure your strap slides over your beam freely.



Put Construction Adhesive on the inside of strap.

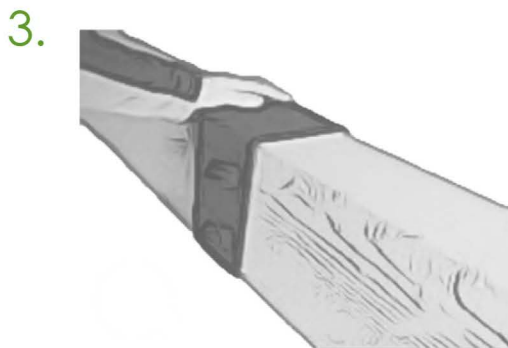

Slide strap over the beam in desired location.

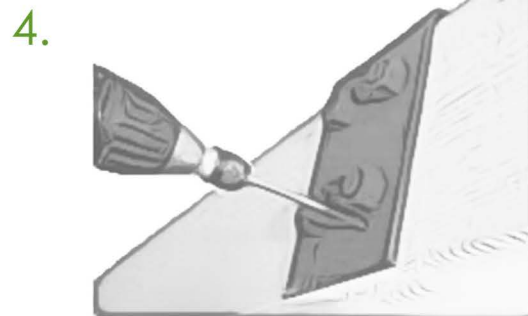

Put trim head or finishing screws through the holes of the straps.

Note: You can use black caulking or filler to hide screw heads.